

PROPOSED LANDSCAPING	
(5) MOCK ORANGE - <i>Philadelphus lewisii</i>	-SYMBOL INDICATES LOCATION OF LOW SHRUB
(8) MANZANITA - <i>Arctostaphylos hookeri</i>	-SYMBOL INDICATES LOCATION OF HIGH SHRUB
INTERSECTIONS OF TRIANGLES INDICATE LOCATION OF MINIMUM 4" POT SIZE KINNICKINIC GROUNDCOVER PLANTING LOCATION. PLANTS SHALL BE SPACED AT 12" ON CENTER IN TRIANGULAR PATTERN	
- BARKDUST ALLOWED AT UNDERSIDE OF TREE AREAS	
NOTE: LANDSCAPING IS TO BE MANUALLY IRRIGATED	

LANDSCAPING/MATERIAL PERCENTAGES	
SITE AREA (POST-DEDICATION)-	20,778 ft ²
LANDSCAPING -	8,059 ft ² (30.18%)
CONC. WALKWAYS-	1,855 ft ²
CONCRETE DRIVEWAYS-	2,163 ft ²
ASPHALT-	3,761 ft ² (14%)
EXISTING CONC. DRIVEWAY -	267 ft ²

TREE KEY	LANDSCAPING KEY
(A)	(6) ASH, OREGON - <i>Fraxinus latifolia</i> -SYMBOL INDICATES LOCATION OF MEDIUM TREE - MEDIUM TREE REQUIRES MINIMUM 5'x5' PLANTING AREA - 1.5" CALIPER AT TIME OF PLANTING
(RA)	(6) RED ALDER - <i>Alnus rubra</i> -SYMBOL INDICATES LOCATION OF MEDIUM TREE - MEDIUM TREE REQUIRES MINIMUM 5'x5' PLANTING AREA - 1.5" CALIPER AT TIME OF PLANTING
(BM)	(6) BIG LEAF MAPLE - <i>Acer macrophyllum</i> -SYMBOL INDICATES LOCATION OF MEDIUM TREE - MEDIUM TREE REQUIRES MINIMUM 5'x5' PLANTING AREA - 1.5" CALIPER AT TIME OF PLANTING
(IC)	(6) INCENSE CEDAR - <i>Calocedrus decurrens</i> -SYMBOL INDICATES LOCATION OF MEDIUM TREE - MEDIUM TREE REQUIRES MINIMUM 5'x5' PLANTING AREA - 5' OF HEIGHT AT TIME OF PLANTING
(RC)	(3) WESTERN RED CEDAR - <i>Thuja plicata</i> -SYMBOL INDICATES LOCATION OF MEDIUM TREE - MEDIUM TREE REQUIRES MINIMUM 5'x5' PLANTING AREA - 1.5" CALIPER AT TIME OF PLANTING

4330 NE GOING ST, PORTLAND, OR 97218	4340 NE GOING ST, PORTLAND, OR 97218
City: PORTLAND	City: PORTLAND
Property ID: R275729	Property ID: R275728
Tax Roll: STEIGERWALD ADD, BLOCK 3, LOT 33	Tax Roll: STEIGERWALD ADD, BLOCK 3, LOT 32 EXC PT IN ST
Use: RESIDENTIAL IMPROVED	Use: RESIDENTIAL IMPROVED
Lot: 33	Lot: 32
Block: 3	Block: 3
County: M	County: M
State ID: 1N2E19BC 14600	State ID: 1N2E19BC 14500
New State ID: 1N2E19BC -14600	New State ID: 1N2E19BC -14500
Alt Account Number: R793502550	Alt Account Number: R793502520
Map Number: 2535 OLD	Map Number: 2535 OLD
Land Type: RES - RESIDENTIAL LAND	Land Type: RES - RESIDENTIAL LAND
Zoning: R7	Zoning: R7

4330 NE GOING ST, PORTLAND, OR 97218	4340 NE GOING ST, PORTLAND, OR 97218
City: PORTLAND	City: PORTLAND
Property ID: R275729	Property ID: R275728
Tax Roll: STEIGERWALD ADD, BLOCK 3, LOT 33	Tax Roll: STEIGERWALD ADD, BLOCK 3, LOT 32 EXC PT IN ST
Use: RESIDENTIAL IMPROVED	Use: RESIDENTIAL IMPROVED
Lot: 33	Lot: 32
Block: 3	Block: 3
County: M	County: M
State ID: 1N2E19BC 14600	State ID: 1N2E19BC 14500
New State ID: 1N2E19BC -14600	New State ID: 1N2E19BC -14500
Alt Account Number: R793502550	Alt Account Number: R793502520
Map Number: 2535 OLD	Map Number: 2535 OLD
Land Type: RES - RESIDENTIAL LAND	Land Type: RES - RESIDENTIAL LAND
Zoning: R7	Zoning: R7

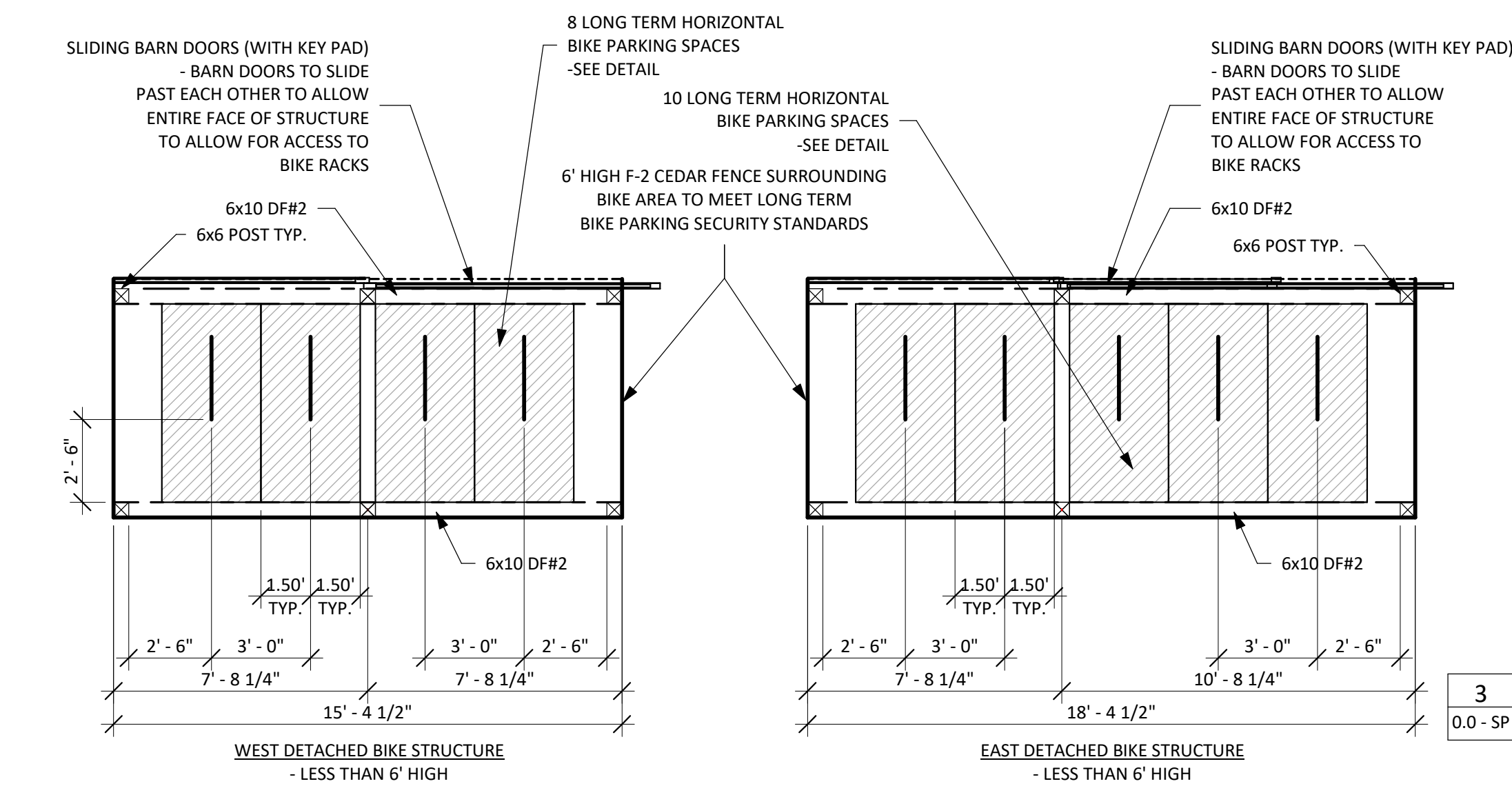
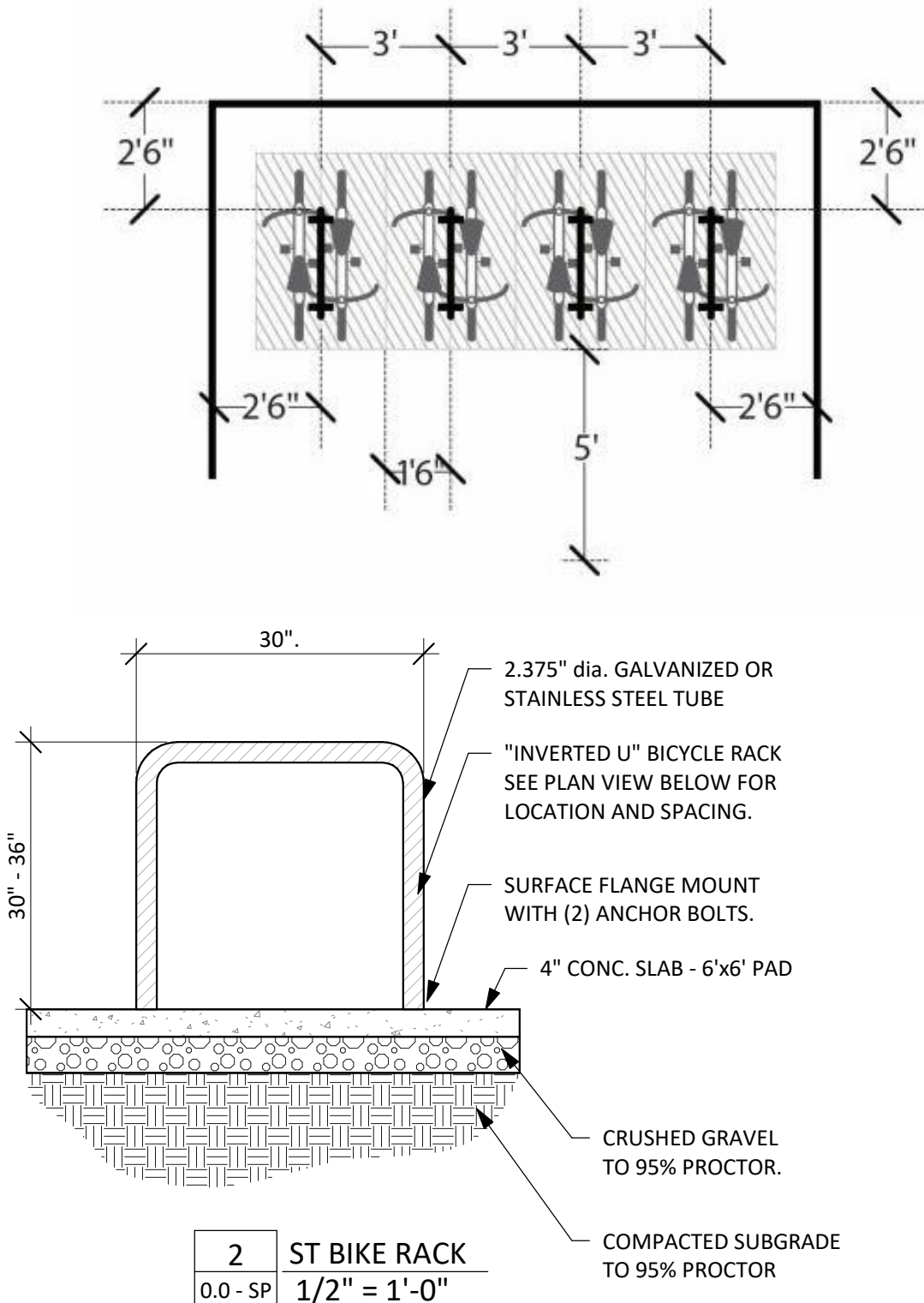
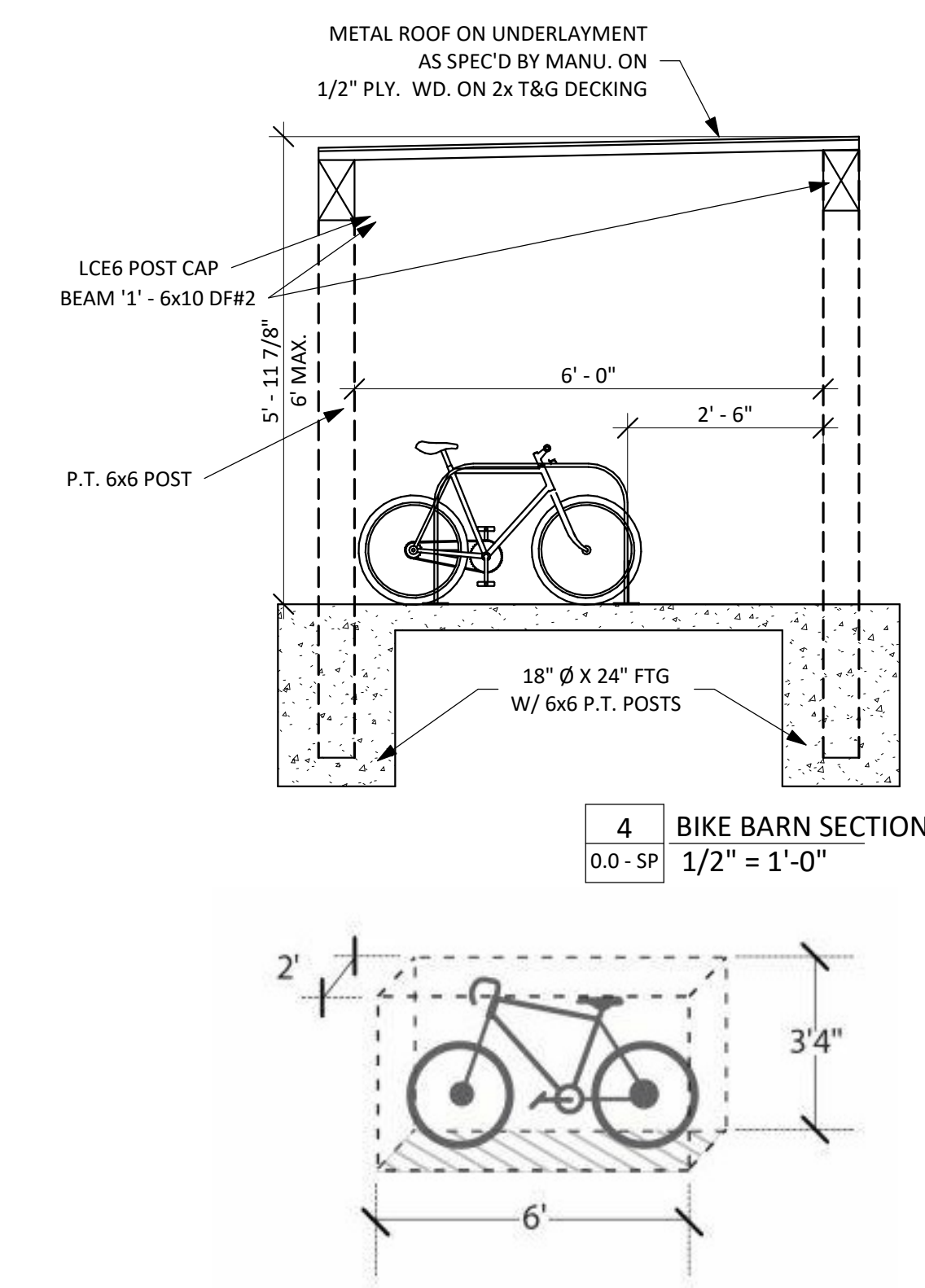

COTTAGE CLUSTERS	
SITE AREA (AFTER DEDICATION)-	20,778 ft ²
MAX. BUILDING COVERAGE (PER UNIT)-	900 ft ²
COMMON OUTDOOR AREA (200 ft ² PER UNIT)-	3,200 ft ² MIN.
NOTE: MIN. 6' OF SEPERATION REQUIRED	
BIKE PARKING	
STANDARD B REQUIRED (2 OR 1.1 PER UNIT)	18 MIN.
LONG TERM BIKE PARKING SPOTS-	2
SHORT TERM BIKE PARKING SPOTS-	

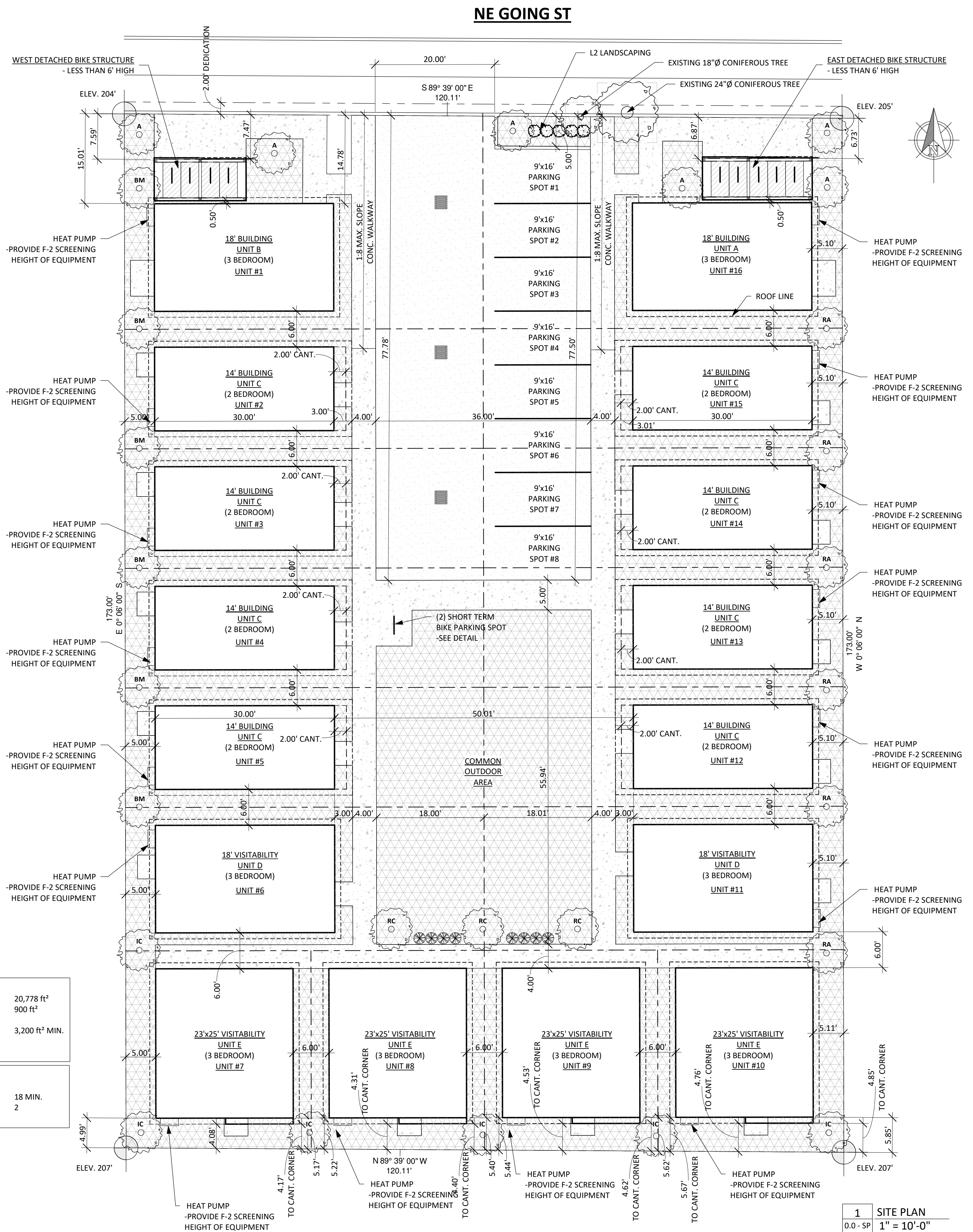

PROVISION GROUP
4340 NE GOING ST
SITE PLAN

No.	Date	Issued by

Project number: 13065
Date: 8/16/2023 9:54:05 AM
Drawn by: BSJ/CHT
Area: -
Scale: As indicated

0.0 - SP